

PENWOOD 232 SLIDING SERIE PVC PROFILE SYSTEM

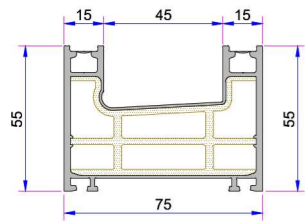

Penwood Double Rail Frame Profile
P.A.232.1106.600.2.BC.01

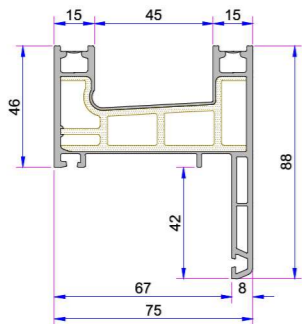

Penwood Double Rail Frame with Sill
P.A.232.1107.600.2.BC.01

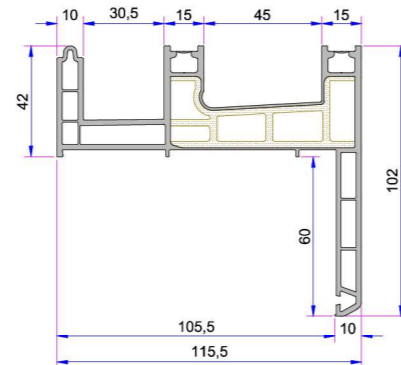

Double Rail Frame Profile With Fly-Screen 60 mm Sill
P.A.232.1109.600.2.BC.01

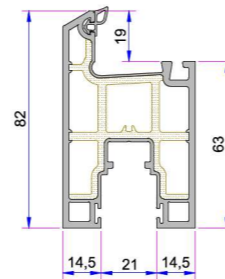

Penwood Sliding System Sash Profile
P.A.232.2308.600.2.BC.01

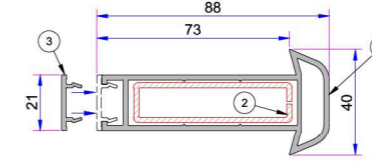

- Universal Large Coupling Profile**
P.A.058.5000.600.0.00.19
- Reinforcement (15x60)**
1,2mm - 34022 - 12123
1,5mm - 34022 - 15123
2 mm - 34022 - 20123
- Universal Large Coupling Cover Profile**
P.A.058.5707.600.0.00.19

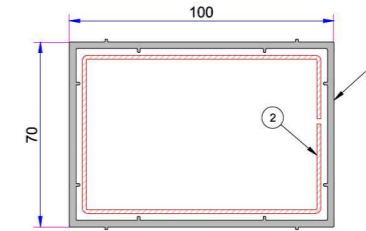

- Box Profile (70x100)**
P.A.070.5202.600.0.00.19
- Reinforcement (60x90)**
1,2mm - 34022 - 12121
1,5mm - 34022 - 15121
2 mm - 34022 - 20121

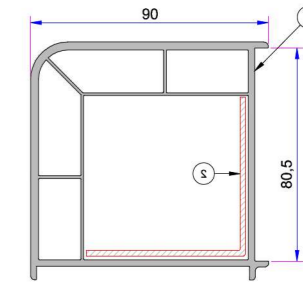

- 90° Corner Profile**
P.A.080.5100.600.0.00.19
- Reinforcement (60x60)**
1,2mm - 34022 - 12306
1,5mm - 34022 - 15306
2 mm - 34022 - 20306

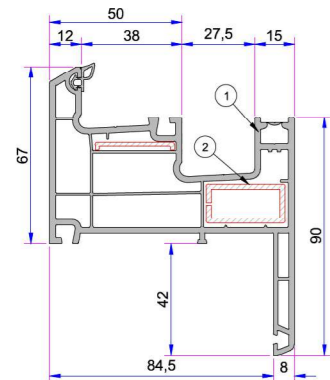

- Single Rail Frame With Sill**
P.A.232.1114.600.0.00.01
- Reinforcement (30x15)**
1,2mm - 34022 - 12135
1,5mm - 34022 - 15135
2 mm - 34022 - 20135

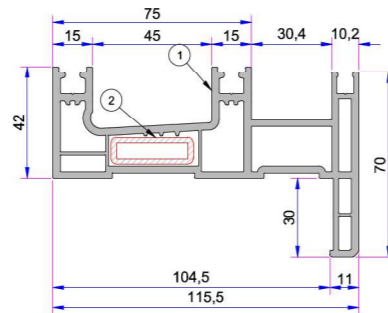

- Frame Profile with Internal Fly-Screen**
P.A.242.1109.600.0.00.01
- Reinforcement (30x10)**
1,2mm - 34022 - 12107
1,5mm - 34022 - 15107
2 mm - 34022 - 20107

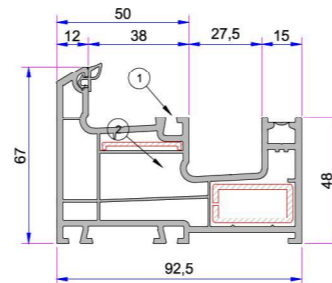

- Single Rail Frame Profile**
P.A.232.1105.600.0.BC.01
- Reinforcement (30x15)**
1,2mm - 34022 - 12135
1,5mm - 34022 - 15125
2 mm - 34022 - 20125

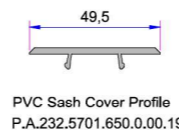

PVC Sash Cover Profile
P.A.232.5701.650.0.00.19

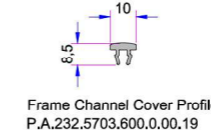

Frame Channel Cover Profile
P.A.232.5703.600.0.00.19

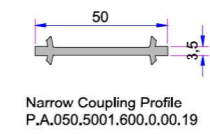

Narrow Coupling Profile
P.A.050.5001.600.0.00.19

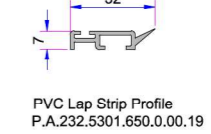

PVC Lap Strip Profile
P.A.232.5301.650.0.00.19

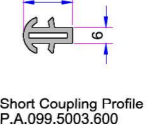

Short Coupling Profile
P.A.099.5003.600



Universal Short Coupling Profile
P.A.099.5004.600.0.00.19

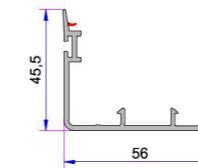

PVC Sash Cover Profile
P.A.232.5709.600.0.00.01

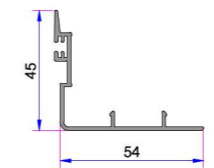

Alm. Sash Cover Profile
16051.601.5.1.1.9016

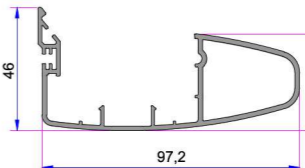

Alm. Sash Cover Grillage Profile
16028.601.5.2.0.9016

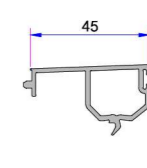

PVC Cover Profile
P.A.232.5710.600.0.00.19

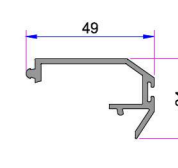

Alm. Cover Profile
AD 16 - 013

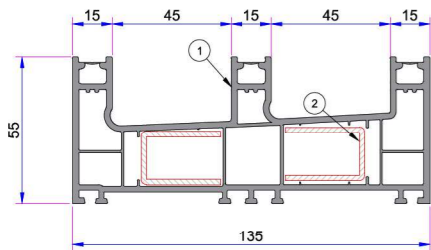

- Triple Rail Frame Profile**
P.A.232.
- Reinforcement (30x20x30)**
1,2mm - 34022 - 12006
1,5mm - 34022 - 15006
2 mm - 34022 - 20006

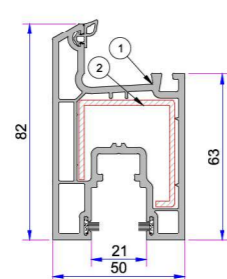

- Sliding System Sash Profile (Static)**
P.A.232.2308.600.0.BC.01
- Reinforcement (30x36x40x7)**
1,2mm - 34022 - 12036
1,5mm - 34022 - 15036
2 mm - 34022 - 20036

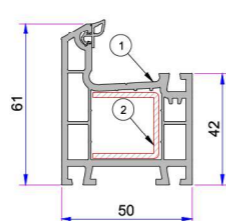

- 332 Frame Profile**
P.A.332.1000.600.0.BC.01
- Reinforcement (25x25x25)**
1,2mm - 34022 - 12003
1,5mm - 34022 - 15003
2 mm - 34022 - 20003

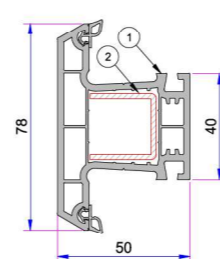

- 332 Mullion Profile**
P.A.332.3000.600.0.BC.01
- Reinforcement (25x25x25)**
1,2mm - 34022 - 12003
1,5mm - 34022 - 15003
2 mm - 34022 - 20003

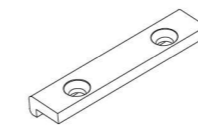

Upper Bedding Piece For Sliding Rail
34009 - 36010

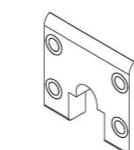

Sliding Sash End Bit
34009 - 46010

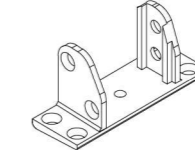

232 Mullion Connector
34007 - 14030

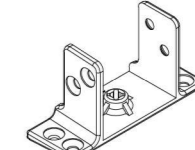

332 Mullion Connector
34007 - 11080

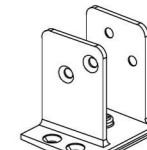

Frame - Frame Connector
34007-14020

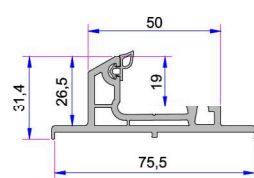

Double Rail Adapter Profile
P.A.232.5800.600.0.BC.19

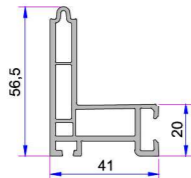

Screen Adapter Profile
P.A.232.5802.600.0.00.19

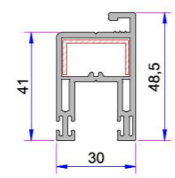

Fly-Screen Sash Profile
P.A.242.2305.600.0.00.01

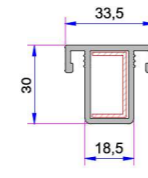

Fly-Screen Mullion Profile
P.A.242.3200.600.0.00.01

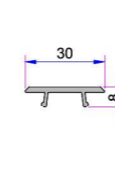

Screen Sash Cover Profile
P.A.242.5701.600

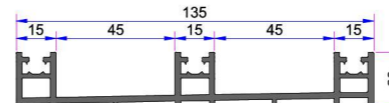

Alm. Triple Rail Threshold
AD16-035

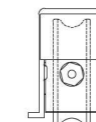

Sliding Roller
34009 - 18030

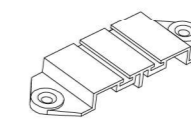

Sealing Bit Single Rail
34009 - 26010

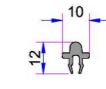

Aluminium Sliding Rail Profile
AD16-014 PRES

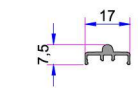

Aluminium Sliding Rail Profile
AD-16-053

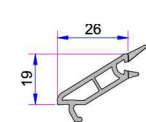

Single Glazing Bead (4 mm)
P.A.332.4000.600.0.HC

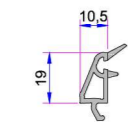

Double Glazing Bead (20 mm)
P.A.332.4100.600.0.HC

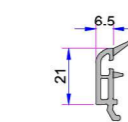

Double Glazing Bead (24 mm)
P.A.532.4500.600.0.HC

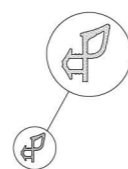

Frame Seal

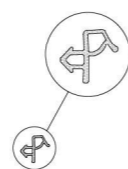

Sash Seal

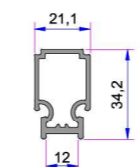

Alm. Double Rail Adaptor Profile
16011.601.5.1.1.9016

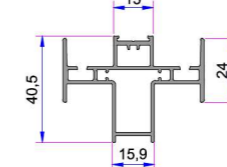

With Alum. Lug Double Sash Middle Adaptor (In Process)

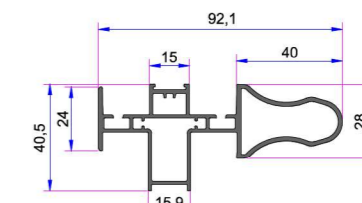

With Alum. Grillage Double Sash Middle Adaptor (In Process)

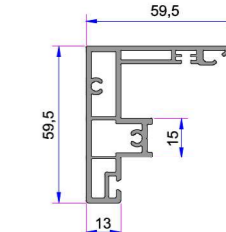

Alm. Sliding Mullion with Three Chambered (In Process)